

CAMMINO



High performance products.



## POWERLINE HARMONIZER

*POWER FOR YOUR MUSIC EMOTION*

**Electricity is the key and the harmonizer prepares it to be transformed by Your Hi-Fi chain into music and emotion.**

**The power harmonizer does:**

- Protect Your Hi-Fi chain from voltage spikes and power surges.
- Stabilize the current.
- Eliminate the interferences from industrial and home equipment.
- Keep the harmonic richness of the music signal.
- Dramatically improve the performances of Your audio and video equipment.
- Boost the emotion of music.

**The key points of the Power Harmonizer:**

- Complete passive custom designed circuit.
- Controlled sound stage adjustment.
- Exclusive tuned cabinet.
- THD virtually absent.

**The Cammino power harmonizer beams You directly to the stage in the free emotion of live music.**



# Mod. H 3.1 POWERLINE HARMONIZER

## standard configuration

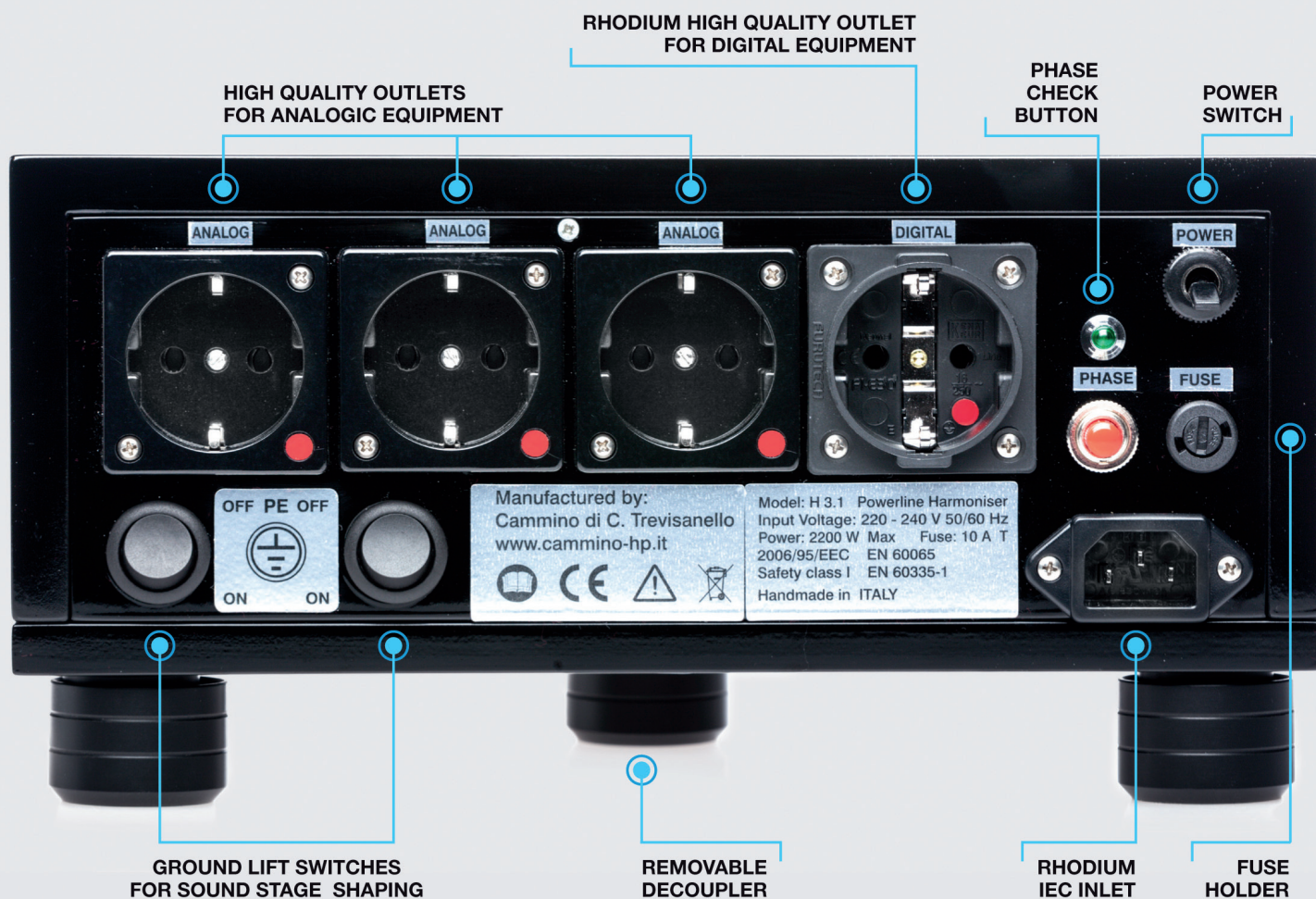

CONFIGURATIONS	ANALOG SOCKETS	DIGITAL SOCKETS
H 3.1	3	1
2.2	2	2
1.3	1	3
<b>TOTAL POWER: 2.200 W</b>		

### TECHNICAL DATA (standard configuration)

Mains Voltage: **220 - 240V AC / 50 - 60 Hz**  
 Total available power: **(220V) 2.200 W**

- Double pole 15 A power switch with low resistance contacts
- Double pole ground lift switches with low resistance contacts
- Phase-check button (to ensure the harmonizer is correctly connected to the wall socket)
- Silver plated fuse holder (10 A fuse T)
- Common mode noise attenuation for frequencies over 100Khz - 65dB (Max)
- Differential mode noise attenuation for frequencies over 100Khz - 90dB (Max)
- Proprietary completely passive design with Power Factor Correction and Total Harmonic Distorsion (THD) virtually absent
- Exclusive cast made of non-conductive, anti resonant, non-magnetic, antistatic material
- Size: (LxHxD) mm 290 x 145 x 215 (removable decoupler included)
- Weight: Kg 5,2

Ask for Your specific configuration

We reserve the right to change the specification without notice

The powerline harmonizer is in conformity with the provisions of the 2006/95/EEC (Low Voltage Directive)



**Cammino** di Claudio Trevisanello  
 Via Tevere 7/D - 30173 Mestre (VE)  
 Tel. +39 041 5340236 - Fax. +39 041 2668593  
[www.cammino-hp.it](http://www.cammino-hp.it) - [info@cammino-hp.it](mailto:info@cammino-hp.it)